

JR **JETBLACK**[™]
ACCESSIBLE PERFORMANCE



S3

Magnetic Trainer
Code: JBT-S3

QUICK START GUIDE



CONTENTS

JETBLACK S3 TRAINER	5
DESIGN SPECIFICATIONS	5
CAUTION & WARNING	7
BICYCLE MOUNTING INSTRUCTIONS	9
USING YOUR TRAINER	12
GETTING THE BEST FROM YOUR TRAINER	13
BIKE REMOVAL & STORAGE	14
CARING FOR YOUR TRAINER	15
JETBLACK WARRANTY	16
JETBLACK SUPPORT	16

**THANK YOU FOR PURCHASING
THE JETBLACK S3 MAGNETIC TRAINER -
SINGLE LEVEL RESISTANCE.**

**PLEASE READ THE FOLLOWING DIRECTIONS
THOROUGHLY BEFORE USE.**

We are committed to your happiness, so if you're not 100% satisfied with your product purchase, just let us know, and we'll fix it.

Thank you for choosing JetBlack.

**LOVE
TO RIDE**

JETBLACK S3 TRAINER

DESIGN SPECIFICATIONS

Total weight	6.1kgs
Max User Weight	120kg
Resistance type	Magnetic
Warranty	1-year Warranty



CAUTION

- Never use the JetBlack S3Trainer on uneven surfaces.
- Hard braking during use may cause excessive wear on bike tyre and the JetBlack S3 Trainer.
- This trainer is intended for single-rider bicycles only.
- Read and follow all of the instructions.
- Always make sure parts are tightened & in good working condition.
- Before beginning each workout, be sure your bike is securely attached to the JetBlack S3Trainer & your tyres are properly inflated.
- The resistance unit can become hot enough to cause burns. Do not touch the resistance unit during use and allow sufficient time to cool after use.
- Keep children and pets away from the JetBlack S3Trainer during use.

WARNING

Read and follow all instructions before use. Failure to securely attach your bike to the Jetblack S3Trainer could result in serious injury.



BICYCLE MOUNTING INSTRUCTIONS

*For best results make sure your tyres are a smooth tread,
(not knobbly) and are inflated similar to if you were riding on the road.*

We recommend 700c Wheels 90 to 110psi. 26" Wheels, 45 to 50psi.

STEP 1

Your trainer comes fully-assembled.

Unfold the frame and unwind the tightening knob as far back as it will go. This will give maximum space later for the tyre when fitting your bike.



STEP 2

Adjust D anti-clockwise to open the resistance unit, giving a gap between your tyre and resistance unit. This makes it easy to mount your bike.

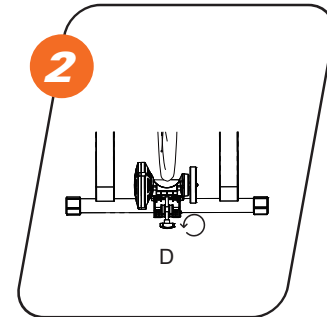

STEP 3

We provide a round ended Quick Release skewer to ensure your bike fits into our trainer. If your Skewer does not look like the one we have provided, for best results please exchange with the JetBlack skewer, flip the existing quick release skewer in your bike and replace it with the one supplied. Simply flip the existing lever up, undo the nut and slide it out. There is no need to change any other settings on the bike.

If your bike uses a Thru Axle system, you will need to purchase a Thru Axle Adaptor. JBT-24. Thru axle bikes will not mount safely onto the S3Trainer

Note: The provided skewer will not work with wheels that have bolt through axles).

Once the replacement skewer is in your bike, you are ready to attach it to the trainer.

Put the rear wheel on the bike trainer. Adjust the tightening screw to clamp the wheel in place. Ensure your tyre is set in the middle of the roller by adjusting the safety screw (A) to stabilise your bike. To lock position, tighten safety knob B.

STEP 4

Adjust the resistance unit to fit snugly up against the fully inflated tyre. The resistance unit should make a good dent in the bike tyre in the same way that a tyre would flatten when you are using it on the road.

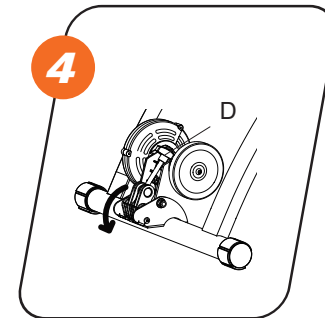
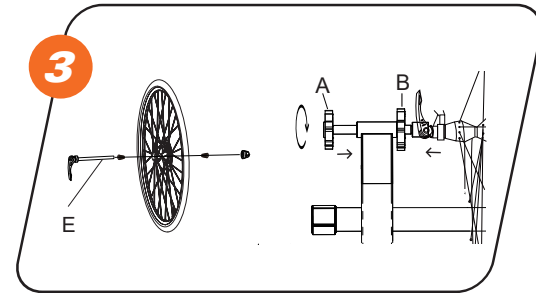

USING YOUR TRAINER

Use your bike's own gears to change resistance.

It is important to warm up properly before doing any kind of exercise, and check to make sure that the bike tyres are inflated to the proper PSI. Always keep both hands on the handle bars when riding.



GETTING THE BEST FROM YOUR TRAINER

The trainer's resistance has been measured on a bike using 700x23c slick road tyres at 110psi with exactly 3 complete turns (six half turns) of the roller adjustment knob after the roller first makes contact with the tyre. If your setup is different, you will have a slightly different resistance, but as long as you keep the setup identical between each training session you will be able to monitor your performance. Ensure tires are inflated between 90 and 110 psi.

To make your indoor workout as quiet as possible, set the trainer on a trainer mat and use a rear tyre with a smooth tread pattern. Once attached, the bicycle slopes downward slightly. To level, use a riser block under the front tyre. For best results use a JetBlack Turn Riser Block.



Recommendation: If you are wanting to connect to training Apps or Platforms, you will need to purchase a Rear wheel Speed / Cadence sensor. JBT-102.

This will enable you to connect and train smart.

BIKE REMOVAL & STORAGE

STEP 1

Be sure to hold onto your bike when loosening it from the JetBlack S3Trainer so that it doesn't fall over.

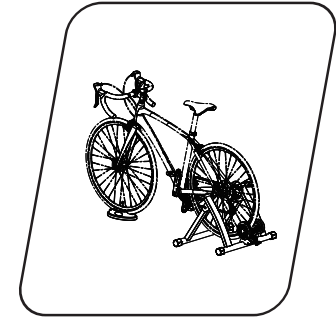

STEP 2

To store your JetBlack S3Trainer, simply fold and store out of the way until your next use. Be careful to avoid pinching your fingers when folding and avoid storing other equipment on top of your trainer.

Caution!

The JetBlack S3 Trainer will become hot during use. Keep children and pets away and allow trainer 15 minutes to cool down before transporting or storing.

CARING FOR YOUR JETBLACK S3 TRAINER

Sweat is extremely corrosive, ensure to wipe any sweat off your JetBlack S3 Trainer after use.

Keep the JetBlack S3 Trainer away from any corrosive substances, such as salt or other potentially hazardous substances.

If the resistance roller darkens, or if there is tyre build up, this can be cleaned with a damp cloth. Clean by rubbing the roller with a side to side motion.

JETBLACK WARRANTY

JetBlack aims to provide the highest possible quality always. However, should you have any issues with your product, please notify us immediately.

The JetBlack S3 Trainer comes with a 1-year Warranty. This warranty does not cover damage caused by misuse, abuse, neglect or an accident. It does not cover general wear and tear, unauthorized modification or failure to follow instructions or warnings in the owner's manual. It is the responsibility of the purchaser to retain receipt for proof of purchase if a warranty claim is required.



SUPPORT

If you have any questions or would like to resolve an issue, please visit the JetBlack Cycling website for trouble shooting information, frequently asked questions and instructional videos.

VISIT: support.jetblackcycling.com/knowledge

MOST IMPORTANTLY...

***LOVE
TO RIDE***



JETBLACK

INTRODUCING THE
TRAINER SUITE



EXPLORE THE FULL RANGE AT
WWW.JETBLACKCYCLING.COM
#LOVETORIDE

YOUR COMPLETE SOLUTION FOR INDOOR TRAINING.

JetBlack Turn Riser Block & Smart Turn Riser Block



JetBlack Trainer Table



JetBlack Rocker Plate



JetBlack TV Stand



JetBlack Trainer Mat



JetBlack Trainer Fan

